

HABITAT

EXCLUSIVE PREVIEW PACKAGE



WELCOME TO HABITAT, A MODERN TAKE ON MOUNT PLEASANT LIVING.

Simple, streamlined, and sleek. Habitat is a contemporary collection of boutique 1, 2 & 3 bedroom homes situated in the core of one of the most coveted neighbourhoods on the east side. Mount Pleasant has long been a hub for pioneers, seekers, and doers. Now we're building a place this creative hub can call home.



Habitat's 70 residences are a modern mix of efficient floor plans spanning 4-storeys. Its prime location on the corner of Guelph St. and E Broadway allow for easy access to the future Mount Pleasant Skytrain Station, just a 5 minute walk away, conveniently connecting Habitat to Vancouver and beyond.





Community is a form of family. It shapes us and defines us.

In addition to private outdoor space for each home, Habitat features a common rooftop patio fit with outdoor BBQ, dining and firepit lounge areas for all residents to take in the spectacular city and mountain views.

Habitat shared workspace and amenity room serves as yet another extension of the home - beautiful space ideal for working from home, hosting functions and bringing community together.



Culture and community are interwoven, and Habitat is committed to cultivating both. Its urban residences are complemented by the contemporary vision for Habitat's commercial space. Not only will the 9 curated shops add character to an area that is undergoing swift evolution, Habitat will bring life to the laneway by activating it with local makers and artisans.



Vancouver's Most Creative Habitat

Located in the heart of the lively and layered Mount Pleasant, this dynamic neighbourhood has gained exponential popularity over the past decade amongst its modern demographic, and for good

reason. Its charismatic streets are dotted with award-winning craft breweries, eclectic boutiques, vibrant murals and artisan pop-ups, alongside new and noteworthy cafes and restaurants.

Live Mount Pleasant



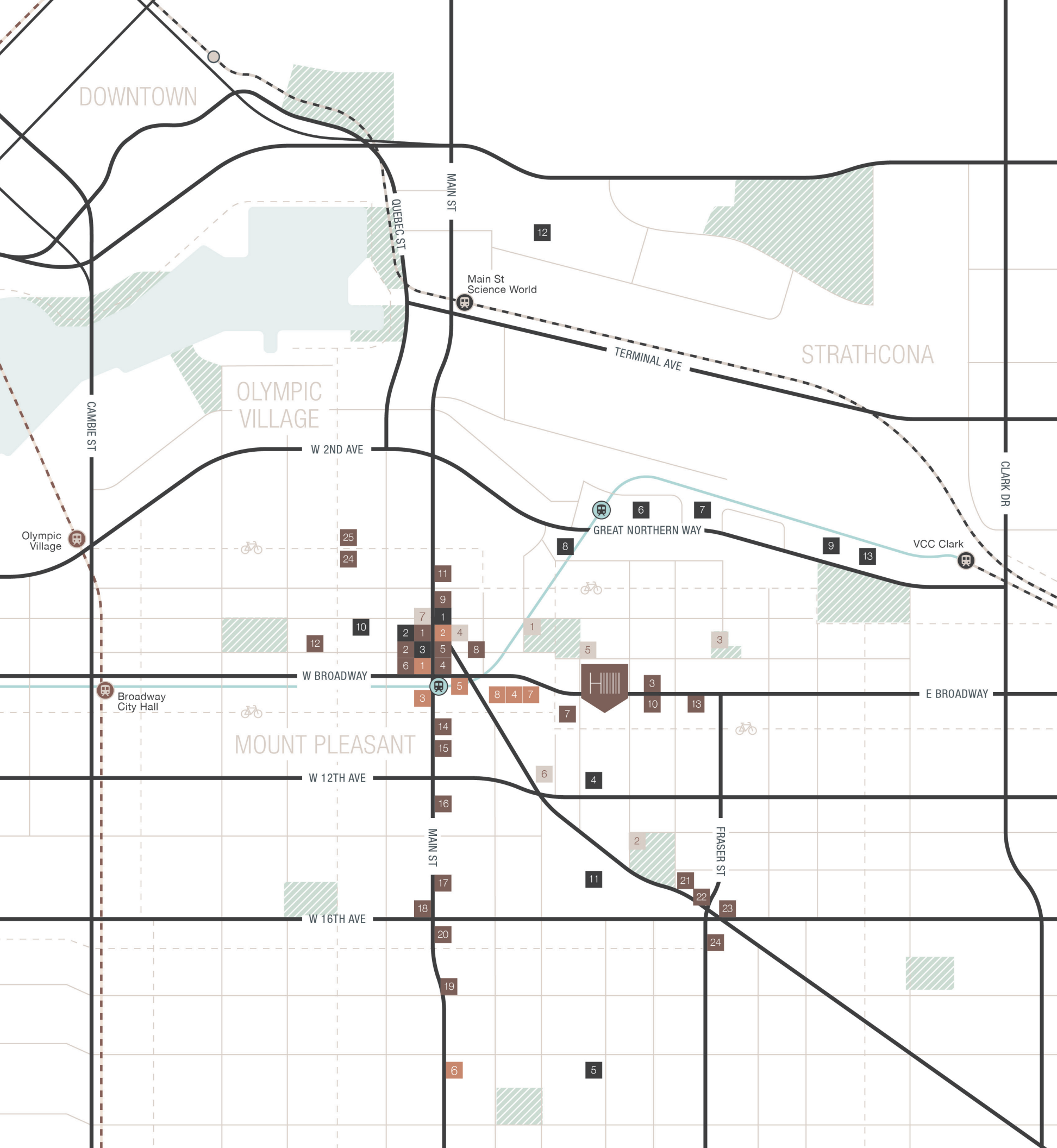

AMENITIES

SHOPPING & AMENITIES

- 1 Local Fashion
 - 8th & Main
 - F as in Frank
 - The Rag Machine
- 2 Pulp Fiction Books
- 3 Much & Little
- 4 Buy Low Foods
- 5 Nesters Market
- 6 Front & Company
- 7 BC Liquor Store
- 8 Shoppers Drug Mart

RECREATION

- 1 Dude Chilling Park
- 2 Robson Park
- 3 Sahalli Park
- 4 Mt Pleasant Community Centre
- 5 Mt Pleasant Farmers Market
- 6 Biltmore Cabaret
- 7 Fox Cabaret

EDUCATION & EMPLOYMENT

- 1 Vancouver Public Library
- 2 Sarah McLachlan School of Music
- 3 Goh Ballet Academy
- 4 Florence Nightingale Elementary
- 5 Sir Charles Tupper Secondary
- 6 Emily Carr University
- 7 Centre for Digital Media
- 8 St Francis Xavier School
- 9 Innovation Hub
- 10 Mount Pleasant Tech Hub (Hootsuite HQ)
- 11 Mount Saint Joseph Hospital
- 12 Site of the future St.Paul's Hospital
- 13 Great Northern Way Tech/Employment Hub (new Lululemon HQ, Nature's Path, MEC, Finning etc.)

CAFES & RESTAURANTS

- 1 Nirvana
- 2 Eight ½ Restaurant
- 3 Paper crane cafe
- 4 The Wallflower
 - Our Town Cafe
- 5 Budgies Burritos
- 6 Fable Diner
- 7 Carp Sushi
- 8 Main St Brewing
- 9 Como Taperia
- 10 The Lido
- 11 Brassneck Brewery
- 12 33 Acres Brewing
- 13 Pizzeria Barbarella
- 14 Cascade Room
- 15 Lucy's Diner
- 16 49th Parallel Café
- 17 Burgoo
- 18 Toshi Sushi
- 19 Anh and Chi
- 20 El Camino's
- 21 Osteria Savio Volpe
- 22 Matchstick Coffee
- 23 Sal y Limon
- 24 Bells and Whistles
- 25 Tacofino Ocho
- 26 Purebread

TRANSPORTATION

- 10th Ave Bike Route
- Millenium/Expo Line Station
- Canada Line Station
- Future Skytrain Stations (Slated for 2025)



HOMES



Light Scheme

Forward-looking Interiors

Habitat's crisp, contemporary interiors are where form meets function. An ode to the philosophy of "less is more," each element is expertly designed to maximize space and visual impact by the award-winning Cristina Oberti Design. Outfitted with natural

tones and textures inspired by its surroundings, each interior stuns with an understated finish and maximum livability. The result is a space that is equally creative as it is comfortable; ripe for the homeowner's next studio project or cocktail hour.



TWO DISTINCT SCHEMES

Light Scheme (Previous Page)

Clean, fresh and contemporary. The light colour scheme at Habitat offers a neutral palette to layer in your own aesthetic. These bright interiors give your home an airy, spacious feel.

Dark Scheme

Bold, modern and distinct. The dark colour scheme at Habitat makes a statement. An impactful collection of finishes for your home that are both contemporary and forward-thinking



With a sleek, current architectural envelope and minimal, modernist interior touches, Habitat's bold design asks its residences to consider what they love and need most in a home, and demand the best of it.



HABITAT

FLOOR 2

- Urban 1 Bedroom
- 2 Bedroom
- 1 Bedroom



DRAFT

In the continuing effort to improve our homes, the developer reserves the right to modify or change plans, specifications, finishes and features without notice. Square footage is approximate only and subject to change. E.&E.O.

HABITAT

FLOOR 3

- Urban 1 Bedroom
- 2 Bedroom
- 1 Bedroom



DRAFT

HABITAT

FLOOR 4

- Urban 1 Bedroom
- 2 Bedroom
- 1 Bedroom
- 3 Bedroom



DRAFT

HABITAT

ROOFTOP

- 1 Bedroom
- 2 Bedroom
- 3 Bedroom

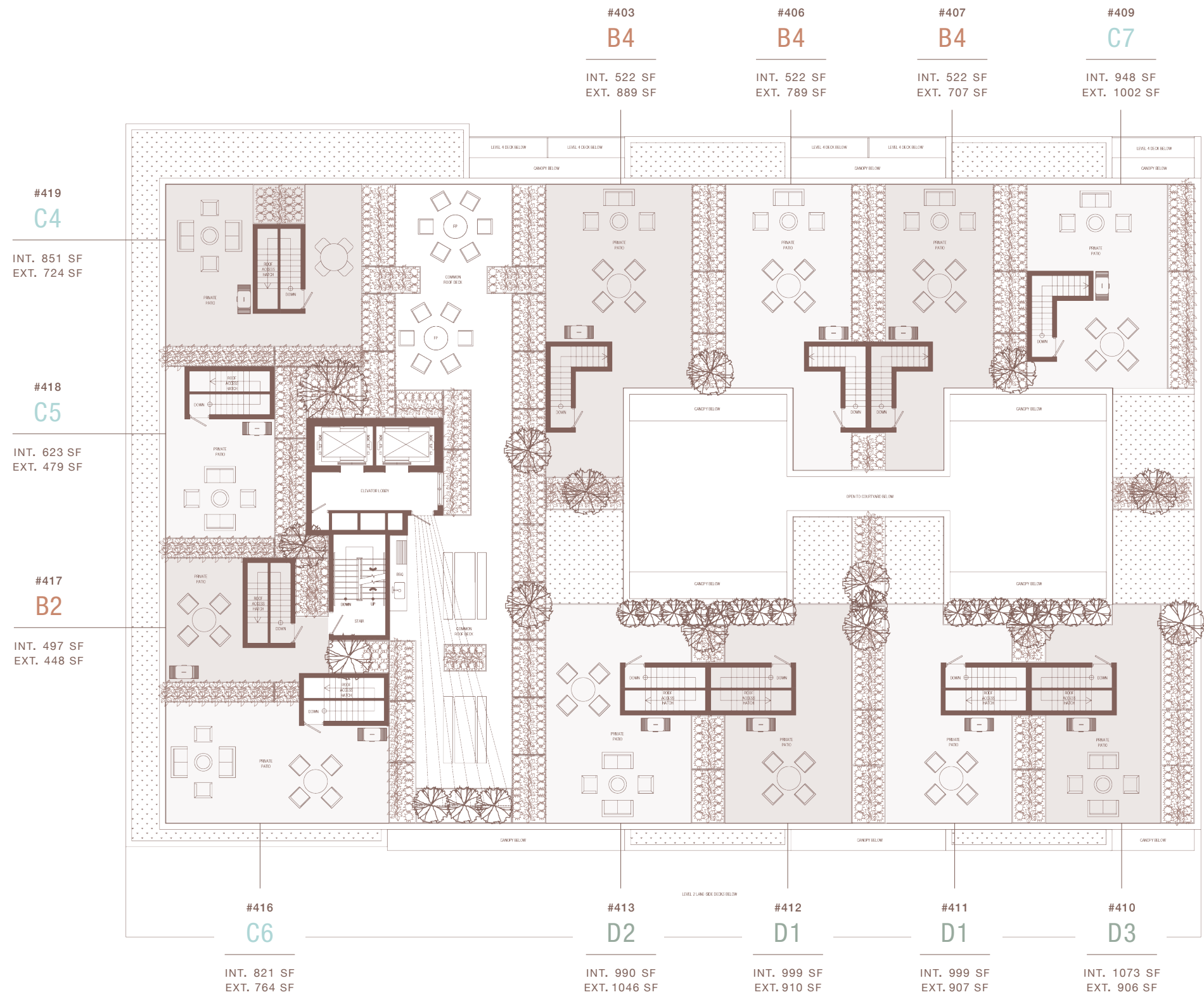

DRAFT

Key Features



HOMES

- Clean contemporary interior design by award-winning Cristina Oberti Design with two colour palettes to choose from: light and dark
- Contemporary laminate flooring throughout the home
- White roller blinds
- Stacking front loading high efficiency washers / dryers
- Gas splitters (BBQ + Firepit) and water bibs on 2nd floor lane-side patios and rooftop patios
- Comprehensive 2/5/10 New home warranty



BUILDING FEATURES

- Boutique 4-storey mixed use building, with retail on the ground level and 70 residences above.
- 9 locally serving curated retail spaces along E Broadway, Guelph and the laneway, bringing life to the lane.
- Secured underground parking*
- Secured storage lockers and bike stall storage*
- Future electric car charging capabilities for all residential parking stalls (upgrade available)
- Common rooftop patio with outdoor BBQ and fire pit lounge areas and flexible amenity room with work stations



KITCHENS

- Wood style accent feature frame and open shelf
- Matte cabinetry with built-in internal drawers
- Quartz countertop and vertical tile backsplash
- Recessed LED puck lighting below upper cabinetry
- Built-in under sink recycling organizer
- Premium Italian Fulgor Milano appliance package with fully integrated fridge and dishwasher for a clean and seamless look



BATHROOMS

- White quartz countertop
- Full height mirror and wood veneer medicine cabinet and vanity with fully integrated LED lighting
- Matte grey porcelain floor tile and modern vertical stack white surround wall tiles and backsplash
- Sleek matte black hardware and plumbing fixtures
- Rain shower head with adjustable handle for spa like experience in all 2 bedroom and 3 bedroom master ensuites

In the continuing effort to improve our homes, the developer reserves the right to modify or change plans, specifications, finishes and features without notice. E.&E.O.

**Ask a sales representative for pricing and availability*

Collaboration is the foundation of life's most memorable projects.

Habitat is a project founded by three local developers with over 70 years of combined experience; Porte, fabric, and Hudson.

The team boasts a legacy of longstanding success developing multi-family homes across East Vancouver and the lower mainland. The development team is passionate about this community and is leveraging the unique strengths and expertise of this collective to ensure that Habitat becomes synonymous with exceptional homes.

Porte, fabric, and Hudson are particularly drawn to Habitat's prime Mount Pleasant location as this is the neighbourhood where the team works, lives, and plays.

The team believes it is vital to create a project that aligns with the unparalleled lifestyle Mount Pleasant offers residents and adds character to an already exciting place to live.

This collective is invested in their local community and can't wait to build an engaging Habitat for the future.

DEVELOPED IN COLLABORATION BY:

porte⁷ + **fabric** + **Hudson.**
homes

SALES & MARKETING BY:

Framework + 
REAL ESTATE GROUP OAKWYN REALTY DOWNTOWN

PAST PROJECTS



Ginger, Vancouver



626 Alexander, Vancouver



Framework, Vancouver

